



Shop Online or Call 714-593-9780



709 bellow components have similar installation sizes as John Crane type 609 metal bellow components.

It has narrow cross-section, making it a good candidate for limited installation space in petro-chemical and chemical processing when the operating temperature is high. Flexible graphite is used as the secondary seal.

If the listed constructing material listed below is not the one you are looking for, please contact us to see whether we can accommodate your needs.

Construction	Standard	Optional
Bellows:	17-4 PH	HC-276, TA2
Secondary Seal:	FKM	FFKM, NBR, HNBR, PTFE-Encapsulated Aflas, Kalrez, Chemrez
Seal Face:	Antimony Impregnated Carbon Graphite	Tungsten Carbide, SIC,
Carbon Graphite Ring Adaptor:	Carp. 42	Duplex, HC-276, TA2
Adaptor:	SS 316L	HC-276, TA2
Operating Non-Concurrent* Limit Temperatures:	-40 to 400 F	
Pressure:	Externally pressurized: Up to 363 psi / 25 bar	
Speed:	Up to 5000 fpm or 25 m/s	

* Any increase in the seal size, or temperature, or rotating speed can reduce the maximum operating pressure limit of the metal bellow component.

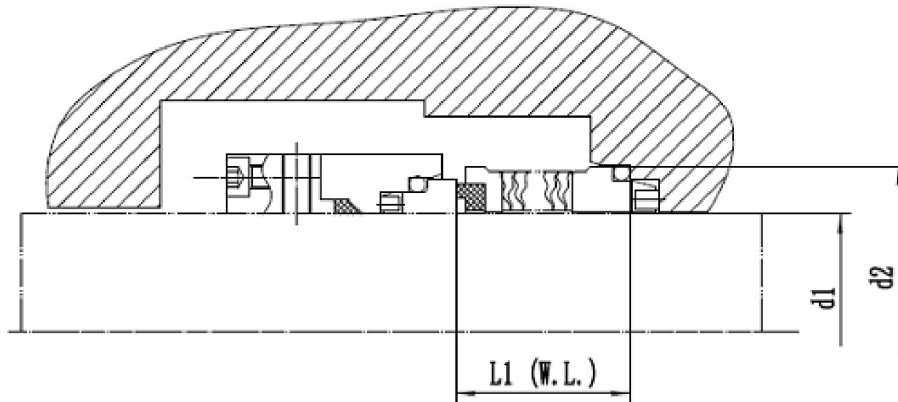

Inches			Metric		
L1 (W. L.)	D2	D1	L1 (W. L.)	D2	D1
1.125	2.062	1.138	28.58	52.37	28.91
1.25	2.187	1.138	31.75	55.55	28.91
1.375	2.312	1.138	34.93	58.72	28.91
1.5	2.562	1.191	38.1	65.07	30.25
1.625	2.562	1.222	41.28	65.07	31.04
1.75	2.687	1.254	44.45	68.25	31.85
1.875	2.812	1.254	47.63	71.42	31.85
2	2.937	1.285	50.8	74.6	32.64
2.125	3.187	1.316	53.98	80.95	33.43
2.25	3.312	1.348	57.15	84.12	34.24
2.375	3.437	1.379	60.33	87.3	35.03
2.5	3.562	1.41	63.5	90.47	35.81
2.625	3.687	1.443	66.68	93.65	36.65
2.75	3.937	1.608	69.85	100	40.84
2.875	4.062	1.608	73.03	103.17	40.84
3	4.187	1.608	76.2	106.35	40.84
3.125	4.312	1.608	79.38	109.52	40.84
3.25	4.437	1.608	82.55	112.7	40.84
3.375	4.562	1.608	85.73	115.87	40.84
3.5	4.687	1.65	88.9	119.05	41.91
3.625	4.812	1.65	92.08	122.22	41.91
3.75	4.937	1.65	95.25	125.4	41.91
3.875	5.062	1.65	98.43	129.57	41.91